

# 150LB FITTINGS

**BSP FULL SOCKET**



Size 1/8" - 6"

**BSP HALF SOCKET**



Size 1/8" - 6"

**BSP RED SOCKET**



Size 1/4" x 1/8" - 4" x 3"

**BSP 90 ELBOW**



Size 1/8" - 4"

**BSP 45 ELBOW**



Size 1/8" - 4"

**MALE/FEMALE 90 ELBOW**



Size 1/8" - 4"

**BSP EQUAL TEE**



Size 1/8" - 4"

**BSP EQUAL CROSS**



Size 1/8" - 3"

**BSP HEXAGON UNION**



Size 1/8" - 4"

**MALE/FEMALE UNION**



Size 1/8" - 2"

**BSP BARREL NIPPLE**



Size 1/8" - 6"

\*Non-standard lengths available

**BSP WELDING NIPPLE**



Size 1/8" - 6"

\*Non-standard lengths available

# 150LB FITTINGS

## BSP HEX NIPPLES



Size 1/8" - 4"

## BSP HEX RED NIPPLE



Size 1/4"x 1/8" - 4" x 3"

## BSP RUNNING NIPPLE



Size 1/8" - 4"

\*Non-standard lengths available

## BSP HOSE TAIL

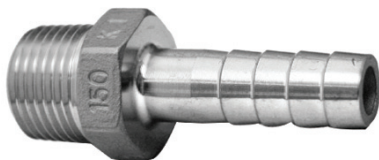

Size 1/8" - 4"

## BSP END CAP



Size 1/8" - 4"

\* Hexagon type also available

## BSP MALE BENDS



Size 1/8" - 2"

## BSP HEXAGON PLUG



Size 1/8" - 4"

\*Also available from bar

## BSP SQUARE PLUG



Size 1/8" - 4"

\*Also available from bar

## BSP HEX RED BUSH



Size 1/4" x 1/8" - 4" x 3"

## BSP HEAVY DUTY FULL SOCKET



Size 1/8" - 6"

\*Material certs available

## BSP HEAVY DUTY HALF SOCKET



Size 1/8" - 6"

\*Material certs available

## BSP HOSE TAIL (BAR)



Size 1/8" - 2"

\*Material certs available

**MANUFACTURED TO BS1740/BS21**

**BSP 150LB THREADED FITTINGS**