

Hexagon Reducing Bush

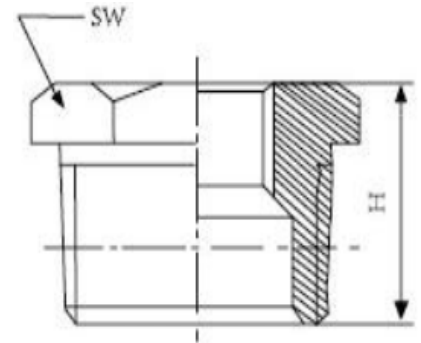

Part Number	Nominal Pipe Size	Rating	SW	L	Weight Kg/Pce
008X006BSPRB	1/4" X 1/8"	150 PSI	15	17	0.02
010X006BSPRB	3/8" X 1/8"	150 PSI	18	18	0.02
010X008BSPRB	3/8" X 1/4"	150 PSI	18	18	0.02
015X006BSPRB	1/2" X 1/8"	150 PSI	23	21	0.03
015X008BSPRB	1/2" X 1/4"	150 PSI	23	21	0.03
015X010BSPRB	1/2" X 3/8"	150 PSI	23	21	0.03
020X008BSPRB	3/4" X 1/4"	150 PSI	28	25	0.06
020X010BSPRB	3/4" X 3/8"	150 PSI	28	25	0.06
020X015BSPRB	3/4" X 1/2"	150 PSI	28	25	0.06
025X008BSPRB	1" X 1/4"	150 PSI	35	27	0.12
025X010BSPRB	1" X 3/8"	150 PSI	35	27	0.12
025X015BSPRB	1" X 1/2"	150 PSI	35	27	0.12
025X020BSPRB	1" X 3/4"	150 PSI	35	27	0.12
032X015BSPRB	1 1/4" X 1/2"	150 PSI	44	29	0.14
032X020BSPRB	1 1/4" X 3/4"	150 PSI	44	29	0.14
032X025BSPRB	1 1/4" X 1"	150 PSI	44	29	0.14

Part Number	Nominal Pipe Size	Rating	SW	L	Weight Kg/Pce
040X015BSPRB	1 1/2" X 1/2"	150 PSI	50	31	0.22
040X020BSPRB	1 1/2" X 3/4"	150 PSI	50	31	0.22
040X025BSPRB	1 1/2" X 1"	150 PSI	50	31	0.20
040X032BSPRB	1 1/2" X 1 1/4"	150 PSI	50	31	0.18
050X015BSPRB	2" X 1/2"	150 PSI	62	35	0.34
050X020BSPRB	2" X 3/4"	150 PSI	62	35	0.34
050X025BSPRB	2" X 1"	150 PSI	62	35	0.34
050X032BSPRB	2" X 1 1/4"	150 PSI	62	35	0.34
050X040BSPRB	2" X 1 1/2"	150 PSI	62	35	0.30
065X040BSPRB	2 1/2" X 1 1/2"	150 PSI	78	38	0.78
065X050BSPRB	2 1/2" X 2"	150 PSI	78	38	0.78
080X040BSPRB	3" X 1 1/2"	150 PSI	92	42	0.95
080X050BSPRB	3" X 2"	150 PSI	92	42	0.95
080X065BSPRB	3" X 2 1/2"	150 PSI	92	42	0.95
100X050BSPRB	4" X 2"	150 PSI	116	49	1.88
100X065BSPRB	4" X 2 1/2"	150 PSI	116	49	1.88
100X080BSPRB	4" X 3"	150 PSI	116	49	1.88

*Cast Grade CF8M (316)

*Male Threads BSP'T (ISO7-1) / Female Threads BSP'P (ISO 228-1)

*Other reductions may be available – Please call if required.

*Dimensions in MM

*Dimensions are for guidance only – Please call to confirm if critical!