

Concentric Reducer

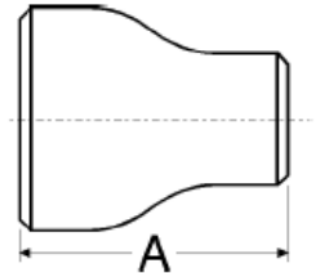

ASTM A403 / ANSI B16.9

Part Number	Dimensions (mm)							
	Nominal Pipe Size	Sch	O/D (LE)	O/D (SE)	Wall (LE)	Wall (SE)	A	Weight Kg/Pce
080X025CX106	3" X 1"	10s	88.9	33.4	3.05	2.77	88.9	0.49
080X032CX106	3" X 1¼"	10s	88.9	42.2	3.05	2.77	88.9	0.48
080X040CX106	3" X 1½"	10s	88.9	48.3	3.05	2.77	88.9	0.51
080X050CX106	3" X 2"	10s	88.9	60.3	3.05	2.77	88.9	0.55
080X065CX106	3" X 2½"	10s	88.9	73.0	3.05	3.05	88.9	0.59
100X040CX106	4" X 1½"	10s	114.3	48.3	3.05	2.77	101.6	0.71
100X050CX106	4" X 2"	10s	114.3	60.3	3.05	2.77	101.6	0.78
100X065CX106	4" X 2½"	10s	114.3	73.0	3.05	3.05	101.6	0.83
100X080CX106	4" X 3"	10s	114.3	88.9	3.05	3.05	101.6	0.87
125X050CX106	5" X 2"	10s	141.3	60.3	3.40	2.77	127.0	1.35
125X065CX106	5" X 2½"	10s	141.3	73.0	3.40	3.05	127.0	1.40
125X080CX106	5" X 3"	10s	141.3	88.9	3.40	3.05	127.0	1.45
125X100CX106	5" X 4"	10s	141.3	114.3	3.40	3.05	127.0	1.49
150X050CX106	6" X 2"	10s	168.3	60.3	2.77	2.77	139.7	1.78
150X065CX106	6" X 2½"	10s	168.3	73.0	3.40	3.05	139.7	1.80
150X080CX106	6" X 3"	10s	168.3	88.9	3.40	3.05	139.7	1.82
150X100CX106	6" X 4"	10s	168.3	114.3	3.40	3.05	139.7	1.95
150X125CX106	6" X 5"	10s	168.3	141.3	3.40	3.40	139.7	2.05
200X100CX106	8" X 4"	10s	219.1	114.3	3.76	3.05	152.4	3.02
200X125CX106	8" X 5"	10s	219.1	141.3	3.76	3.40	152.4	3.08
200X150CX106	8" X 6"	10s	219.1	168.3	3.76	3.40	152.4	3.19

*Grade 316/L

*Schedule 10s Wall Thickness

*Welded Construction

*Dimensions are for guidance only – Please call to confirm if critical!