

90° Long Radius Elbow

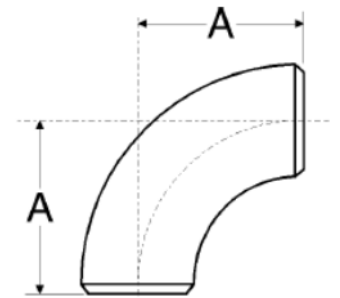

ASTM A403 / ANSI B16.9

Part Number	Nominal Pipe Size	Schedule	Dimensions (mm)			Weight Kg/Pce
			O.D	Wall Thickness	A	
015BWE90X404	1/2"	40s	21.3	2.77	38.1	0.08
020BWE90X404	3/4"	40s	26.7	2.87	38.1	0.09
025BWE90X404	1"	40s	33.4	3.38	38.1	0.16
032BWE90X404	1 1/4"	40s	42.2	3.56	47.6	0.25
040BWE90X404	1 1/2"	40s	48.3	3.69	57.2	0.40
050BWE90X404	2"	40s	60.3	3.91	76.2	0.71
065BWE90X404	2 1/2"	40s	73.0	5.16	95.3	1.36
080BWE90X404	3"	40s	88.9	5.49	114.3	2.18
100BWE90X404	4"	40s	114.3	6.02	152.4	4.17
125BWE90X404	5"	40s	141.3	6.55	190.5	6.86
150BWE90X404	6"	40s	168.3	7.11	228.6	10.89
200BWE90X404	8"	40s	219.1	8.18	304.8	21.55
250BWE90X404	10"	40s	273.1	9.27	381.0	38.56
300BWE90X404	12"	40s	323.9	9.53	190.5	53.00
350BWE90X404	14"	40s	355.6	9.53	533.4	68.00
400BWE90X404	16"	40s	406.4	9.53	609.6	89.20
450BWE90X404	18"	40s	457.2	9.53	685.8	113.0
500BWE90X404	20"	40s	508.0	9.53	762.0	140.0
600BWE90X404	24"	40s	609.6	9.53	914.4	202.0

*Grade 304/L

*Schedule 40s Wall Thickness

*Welded Construction

*Dimensions are for guidance only – Please call to confirm if critical!