

Socket Weld 3000LB 90° Elbow

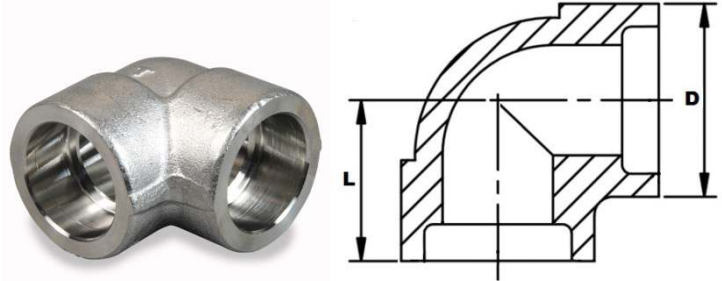

Part Number	Nominal Pipe Size	Rating	D	L	Weight Kg/Pce
008SW3KE90	1/4"	3000 PSI	20.7	21	0.130
010SW3KE90	3/8"	3000 PSI	24.6	24	0.140
015SW3KE90	1/2"	3000 PSI	30.0	26	0.225
020SW3KE90	3/4"	3000 PSI	36.0	32	0.290
025SW3KE90	1"	3000 PSI	44.1	35	0.500
032SW3KE90	1 1/4"	3000 PSI	53.5	40	0.750
040SW3KE90	1 1/2"	3000 PSI	60.2	45	1.100
050SW3KE90	2"	3000 PSI	73.2	54	1.700

*Grade 316

*Dimensions to ANSI B16.11/BS3799

*Dimensions in MM

*Larger sizes are available to order

*Dimensions are for guidance only – Please call to confirm if critical!