

150LB REDUCED THICKNESS FFSO BORED O/D

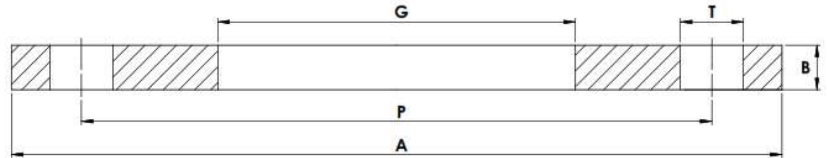

Part Number	Size	A	B	G	P	T	No. of Holes	Kg (Pce)
025F150/ROD6	1"	108	7.14	25.9	79.4	15.9	4	0.48
032F150/ROD6	1¼"	117	7.94	32.3	88.9	15.9	4	0.74
040F150/ROD6	1½"	127	8.73	38.6	98.4	15.9	4	0.92
050F150/ROD6	2"	152	9.53	51.3	120.6	19.0	4	1.26
065F150/ROD6	2½"	178	10.32	64.0	139.7	19.0	4	1.74
080F150/ROD6	3"	190	11.11	76.7	152.4	19.0	4	1.98
100F150/ROD6	4"	229	12.70	102.1	190.5	19.0	8	3.04
125F150/ROD6	5"	254	10.00	131.5	215.9	22.2	8	3.55
150F150/ROD6	6"	279	10.00	156.5	241.3	22.2	8	4.16
200F150/ROD6	8"	343	10.00	206.5	298.4	22.2	8	5.88
250F150/ROD6	10"	406	15.00	256.5	362.0	25.4	12	9.30

*Grade 316/L

*FFSO = Flat Faced Slip On

*ANSI B16.5 150LB Drilling x BS10 'E' / 'D' Thickness

*Dimensions in MM

*Dimensions are for guidance only – Please call to confirm if critical!